

The facade is a kind of renaissance  
extravaganza — brick coloured triangular  
domes at the top, grand french windows,  
crenellated parapets, and stone finish  
external walls form this architectural  
marvel. From the east, which is bordered  
by magnificent sculptured gardens, visitors  
are greeted by a baroque facade.



## Amenities

- ❖ Sculptured landscaped garden with fountains and lightings
- ❖ Swimming Pool
- ❖ Kids' Pool
- ❖ Kids' Play Area
- ❖ Gymnasium
- ❖ Health Club
- ❖ Jacuzzi
- ❖ Home Theatre
- ❖ Banquet
- ❖ Lounge
- ❖ Outdoor Amphitheatre
- ❖ Indoor Games Area
- ❖ Library
- ❖ Children's Play Area,
- ❖ 24 Hour Power Backup
- ❖ CCTV & Surveillance
- ❖ WI FI
- ❖ All modern amenities of a 5 Star resident's club



## Specifications

- ❖ **Structure:-** RCC Frame structure.
- ❖ **Elevation:-** Inspired from architectural wisdom from the Renaissance period.
- ❖ **Exterior:-** Weather proof paint with decorative finish.
- ❖ **Interior Finish:-** Smooth Plaster of Paris wall finish.
- ❖ **Flooring:-** Quality Vitrified tiles of Kajaria or equivalent in Living, Dining, Kitchen and all bedrooms.
- ❖ **Staircase and Lobby:-** Wide specious staircase, elegantly designed Lobby and corridors with high quality marble, kota/granite stone.
- ❖ **Kitchen:-** Granite top platform with stainless steel sink of reputed make, glazed tiles, dado upto 2 feet height above the platform.



- ❖ **Electrical and Voice/Data Points:-** Copper wiring of Finolex or equivalent make. MCB of Havells or equivalent make. AC Point in Master bedroom. Telephone, TV Cable point in Living & Dining. Geysers point in bathroom. Adequate light and fan points. Modular switches from Anchor or equivalent make.
- ❖ **Water Supply:-** 24 hours uninterrupted water supply.
- ❖ **Lift:-** High quality lifts of Otis or equivalent make in each block.
- ❖ **Toilet:-** Elegant CP fittings of Jaquar or equivalent make. Anti skid tiles from Kajaria Ceramics or equivalent make on the floor and walls upto door height. Hot and Cold water plumbing. Western style sanitary fittings of Parryware or equivalent make.
- ❖ **Windows:-** Sliding Premium finish Powder Coated Aluminium.
- ❖ **Doors:-** Entrance – polished flush doors with Godrej night latch. Good quality flush doors in all other rooms.
- ❖ **Hardware:-** Brass and stainless steel hardware fittings of reputed make.

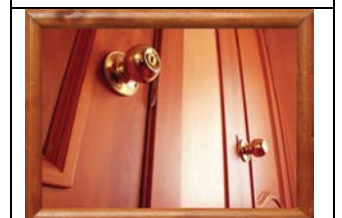



## Location



# Type & Area

## Site Plan

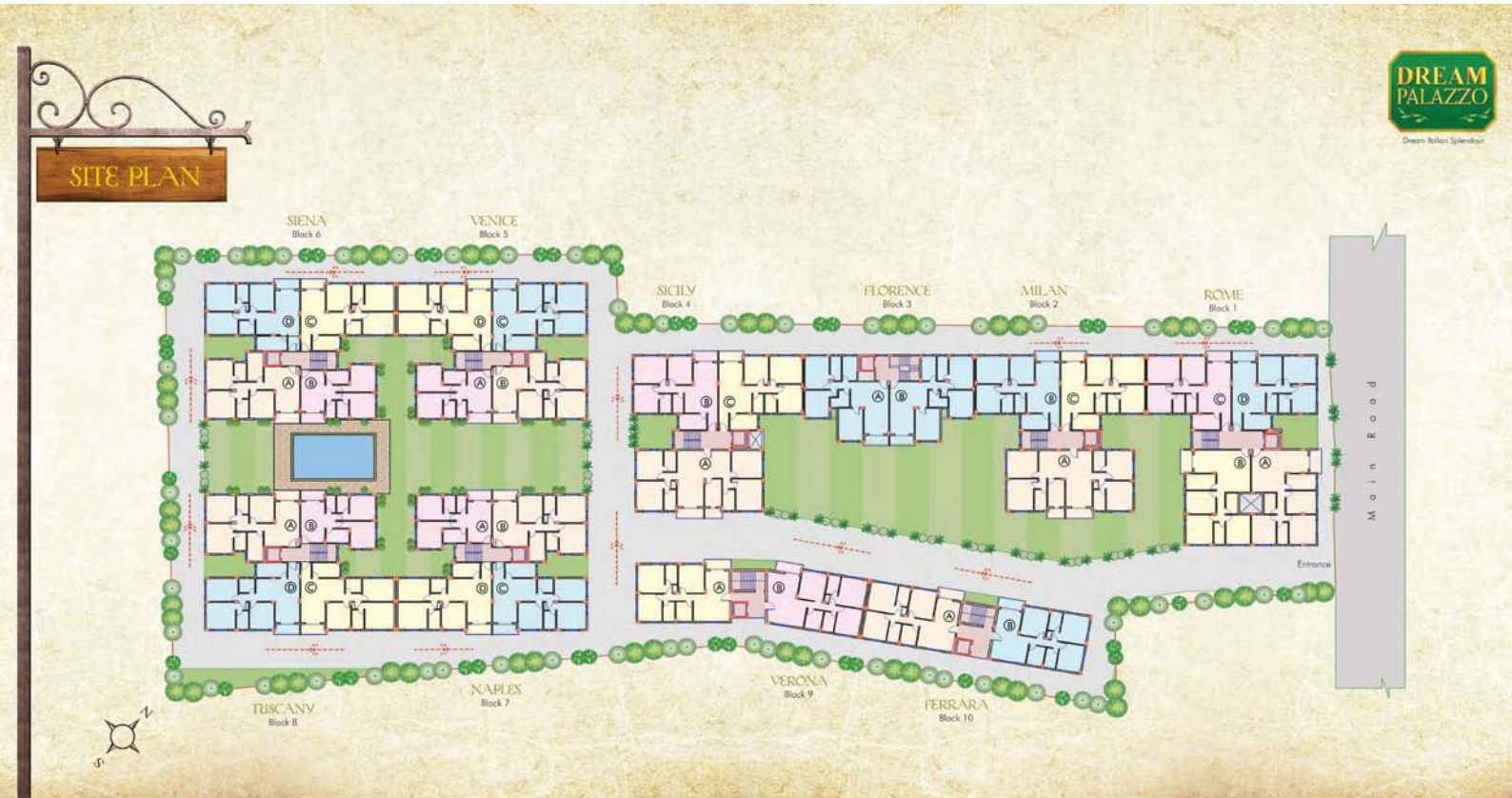



Rome  
Block-1



Flat Marked	Saleable Area	Bed Room
A	1500	3
B	1495	3
C	1390	3
D	1385	3

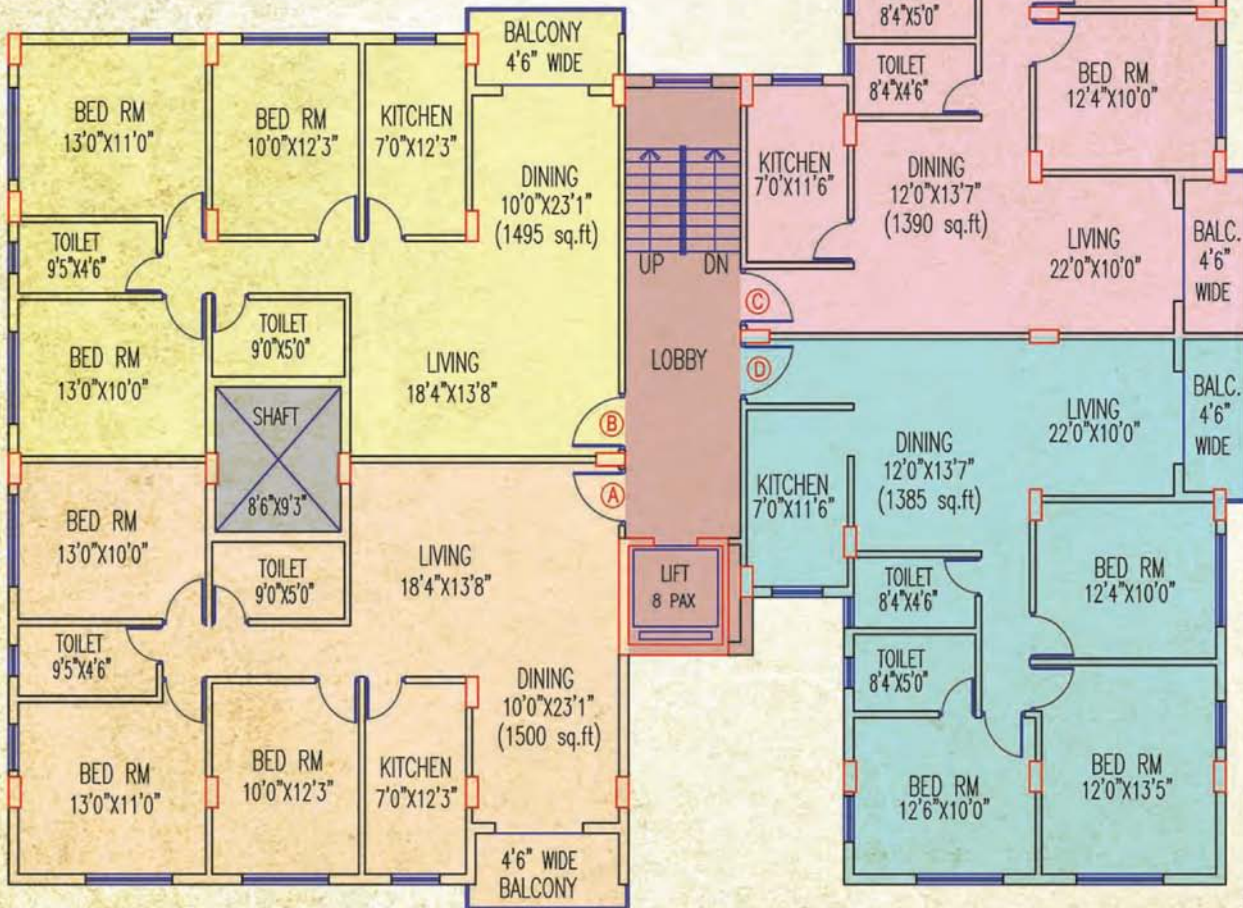

Block 1





Milan  
Block- 2



Block 2



Flat Marked	Saleable Area	Bed Room
A	1990	4
B	1385	3
C	1385	3





**Florence**  
**Block- 3**

Flat Marked	Saleable Area	Bed Room
A	1400	3
B	1400	3

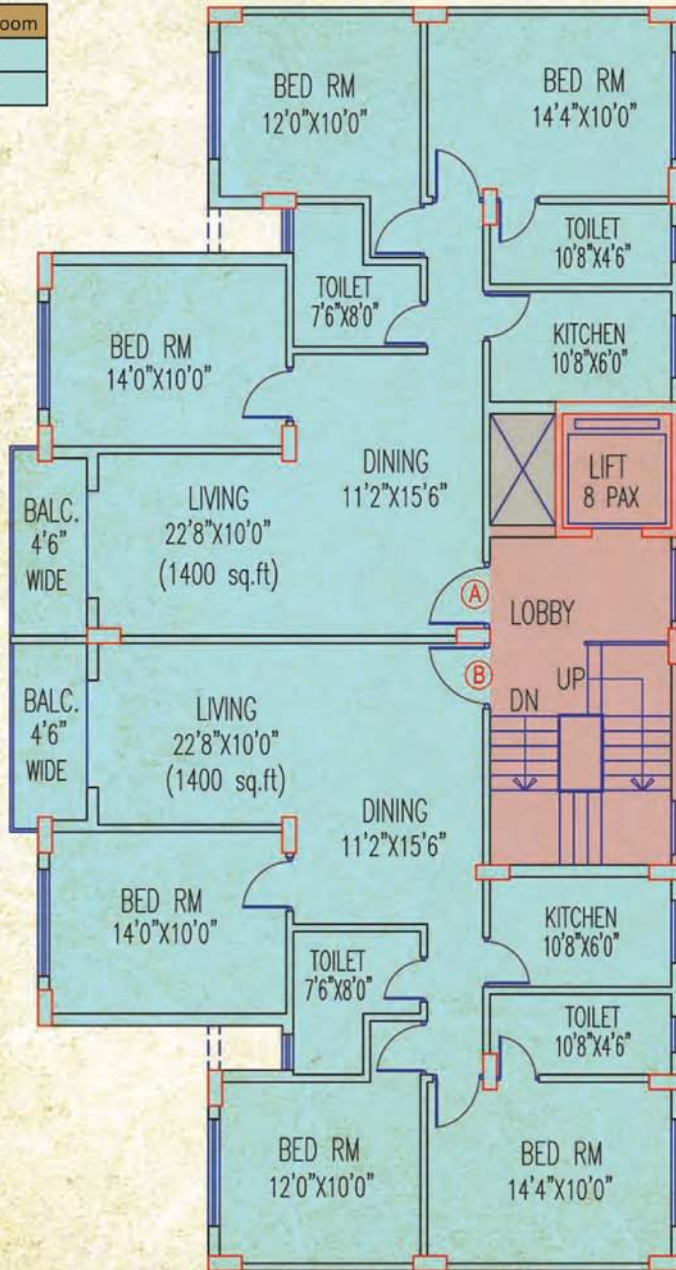

Block 3





Sicily  
Block- 4



Dream Italian Splendour



Block 4

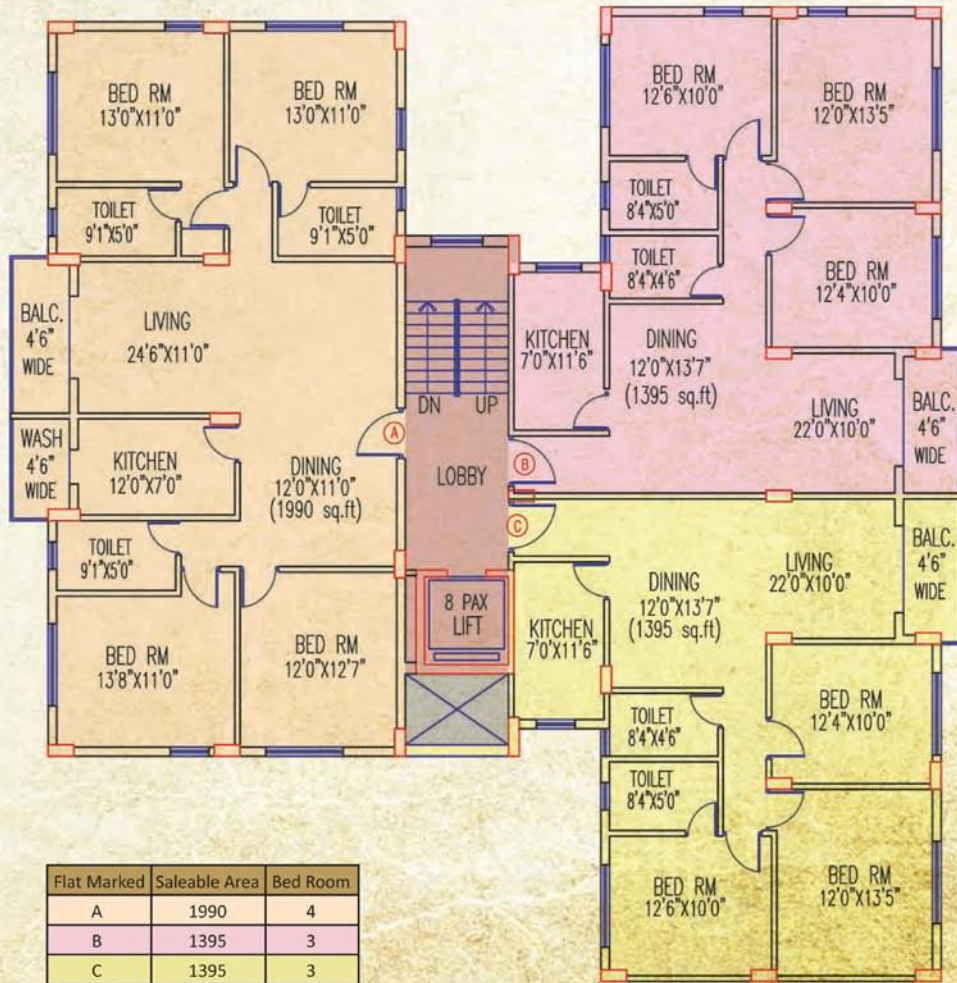



Venice  
Block- 5

Flat Marked	Saleable Area	Bed Room
A	970	2
B	1370	3
C	1400	3
D	1385	3



Block 5

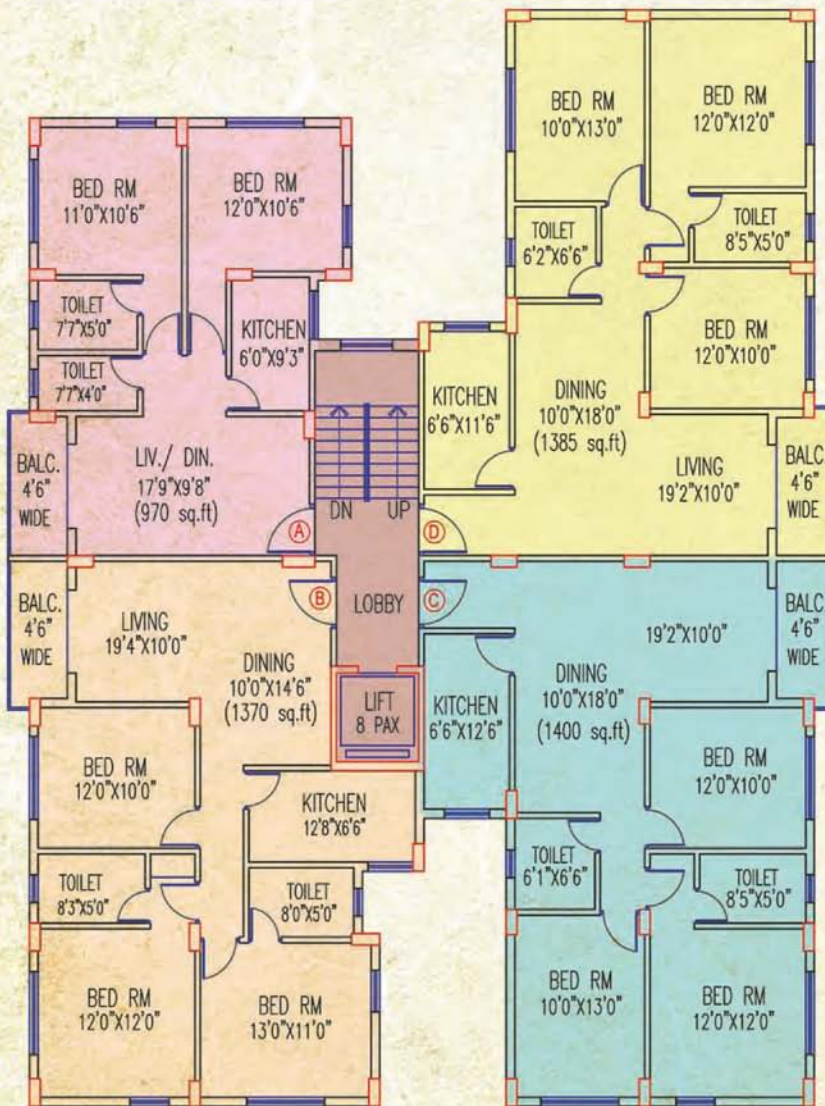



Siena  
Block- 6



Dream Italian Splendour



Block 6

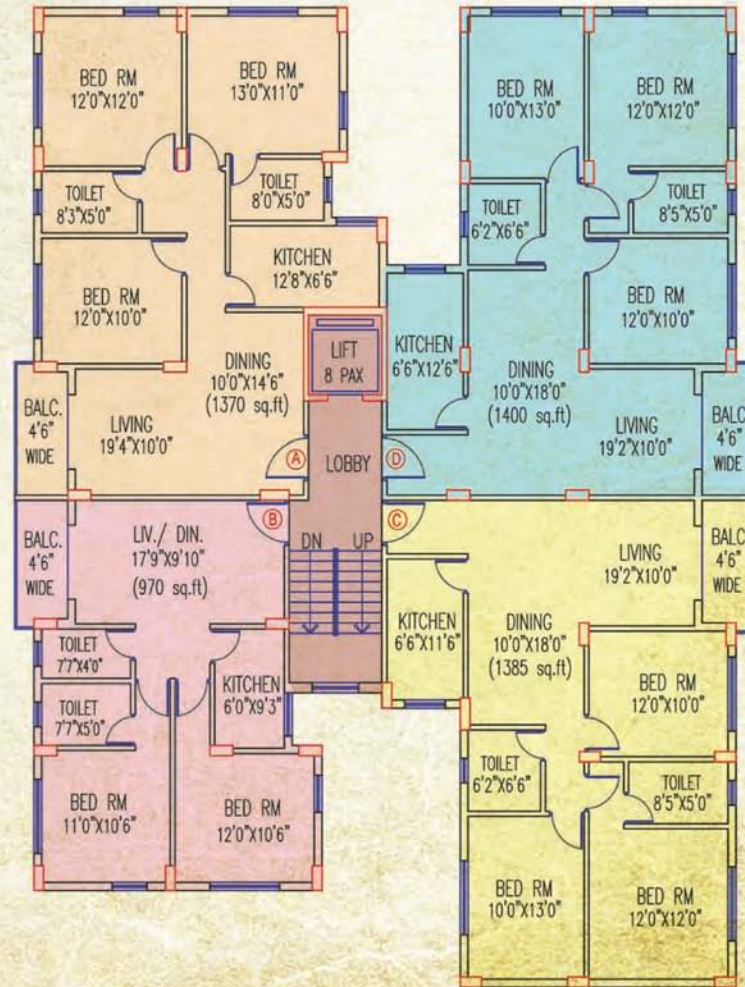

Flat Marked	Saleable Area	Bed Room
A	1370	3
B	970	2
C	1385	3
D	1400	3





Naples  
Block- 7

Flat Marked	Saleable Area	Bed Room
A	970	2
B	1370	3
C	1400	3
D	1385	3



Block 7

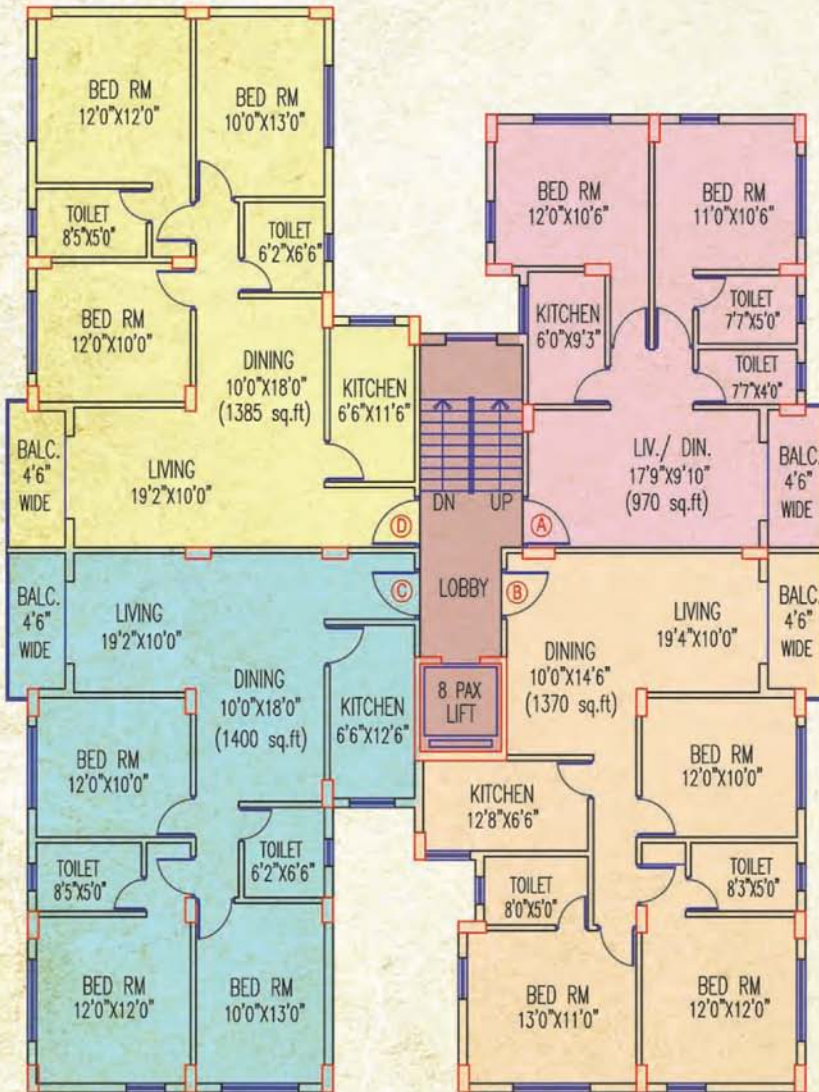



Tuscany  
Block- 8



Block 8

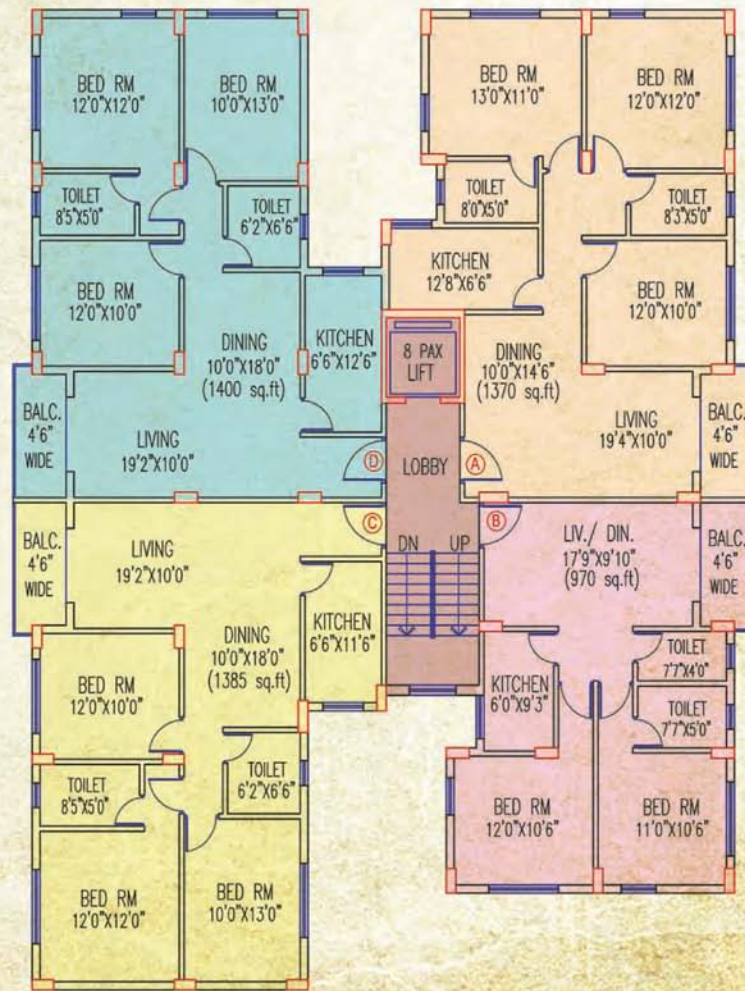

Flat Marked	Saleable Area	Bed Room
A	1370	3
B	970	2
C	1385	3
D	1400	3





Verona  
Block- 9

Flat Marked	Saleable Area	Bed Room
A	1370	3
B	1435	3

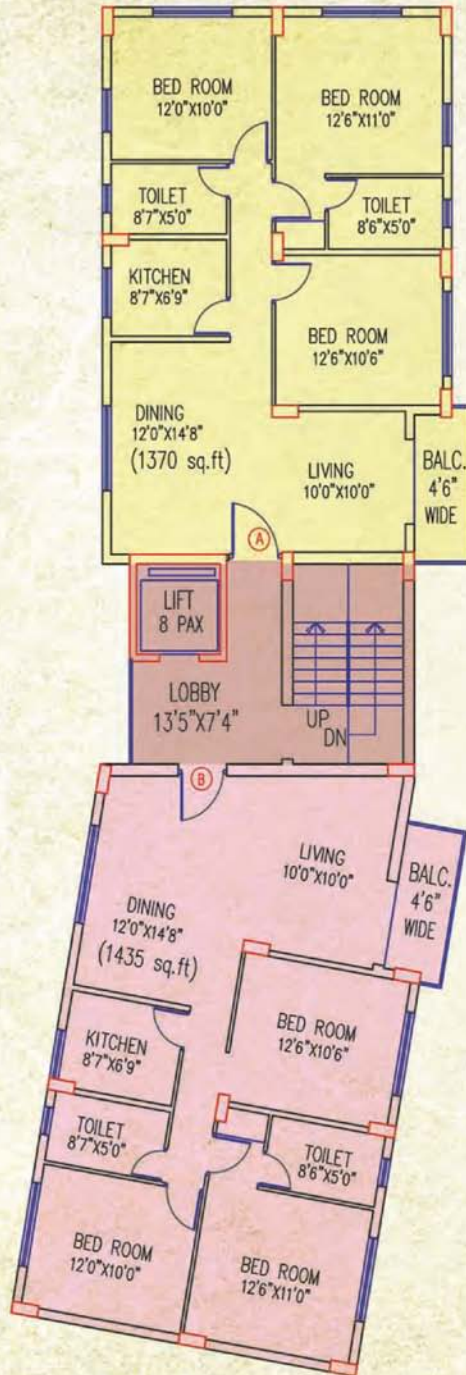

Block 9



Ferrara  
Block- 10



Dream Italian Splendour



Block 10

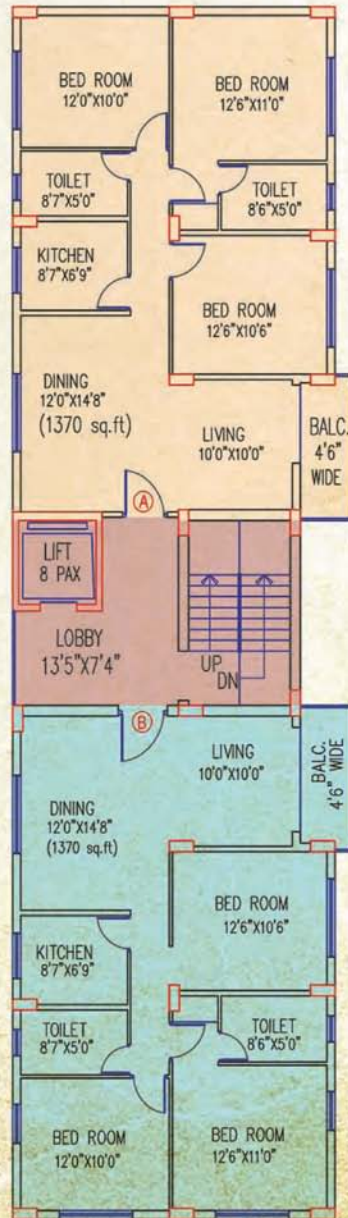

Flat Marked	Saleable Area	Bed Room
A	1370	3
B	1370	3





## Developer



Jain Group

## Architect

Raj Agarwal & Associates



12-A, Lord Sinha Road, Shyamkunj Appt.

Flat # 403, Kolkata 700071 WB

+91 81004 44477



[sales@rabcoestates.com](mailto:sales@rabcoestates.com)