



Amenities & Facilities

Club Facilities:-

- ❖ Health club and gym well equipped with massage room and Jacuzzi
- ❖ Billiards / snooker, table tennis tables, other board games and a card room
- ❖ Badminton / Tennis + Multipurpose court
- ❖ Yoga and Meditation Hall
- ❖ Air conditioned space for home theatre
- ❖ Air conditioned Community Hall for hosting parties attached to open lawn space
- ❖ Swimming pool with attached 'splash pool' for kids and tiny tots with changing rooms
- ❖ Library (space only)

Basic Facilities:-

- ❖ Jogging track
- ❖ Landscaped garden with fountains and lightings
- ❖ Round the clock security with surveillance camera in all common areas
- ❖ Generator backup for automatic lifts and pumps and provision for limited flats requirements (at an extra cost)
- ❖ Rain water harvesting
- ❖ Water filtration plant
- ❖ Gas pipe line (at extra cost)
- ❖ Fire Fighting equipments and extinguishers (at extra cost)
- ❖ Maintenance by an independent professional company
- ❖ Garbage Chute

Specifications

- ❖ **Structure:-** R.C.C. frame structure
- ❖ **Doors:-** Quality wooden frames with solid core flush doors. Main door will have polish finish
- ❖ **Windows:-** Anodized Aluminium window
- ❖ **Flooring:-** Vitrified tiles in all bedrooms and living/dining area
ceramic tiles-anti skid in Kitchen and Toilets
- ❖ **Electricals:-**
Concealed copper wiring with latest switches
Provision for AC points in all bedrooms and TV & Telephone point in living and master bedroom
Provision for power point and exhaust fan points in Kitchen
Provision for power points in Toilets
- ❖ **Kitchen:-**
Counter: Granite slab with stainless steel sink
Walls Tiles: Upto 2 (two) feet height above counter
- ❖ **Toilets:-**
Wall tiles: Ceramic tiles upto 7 feet high (door Height)
Sanitary ware: Quality Chromium plated fittings. White/Ivory coloured porcelain ware
- ❖ **Exterior of Building:-** Latest available durable outer finish

Location

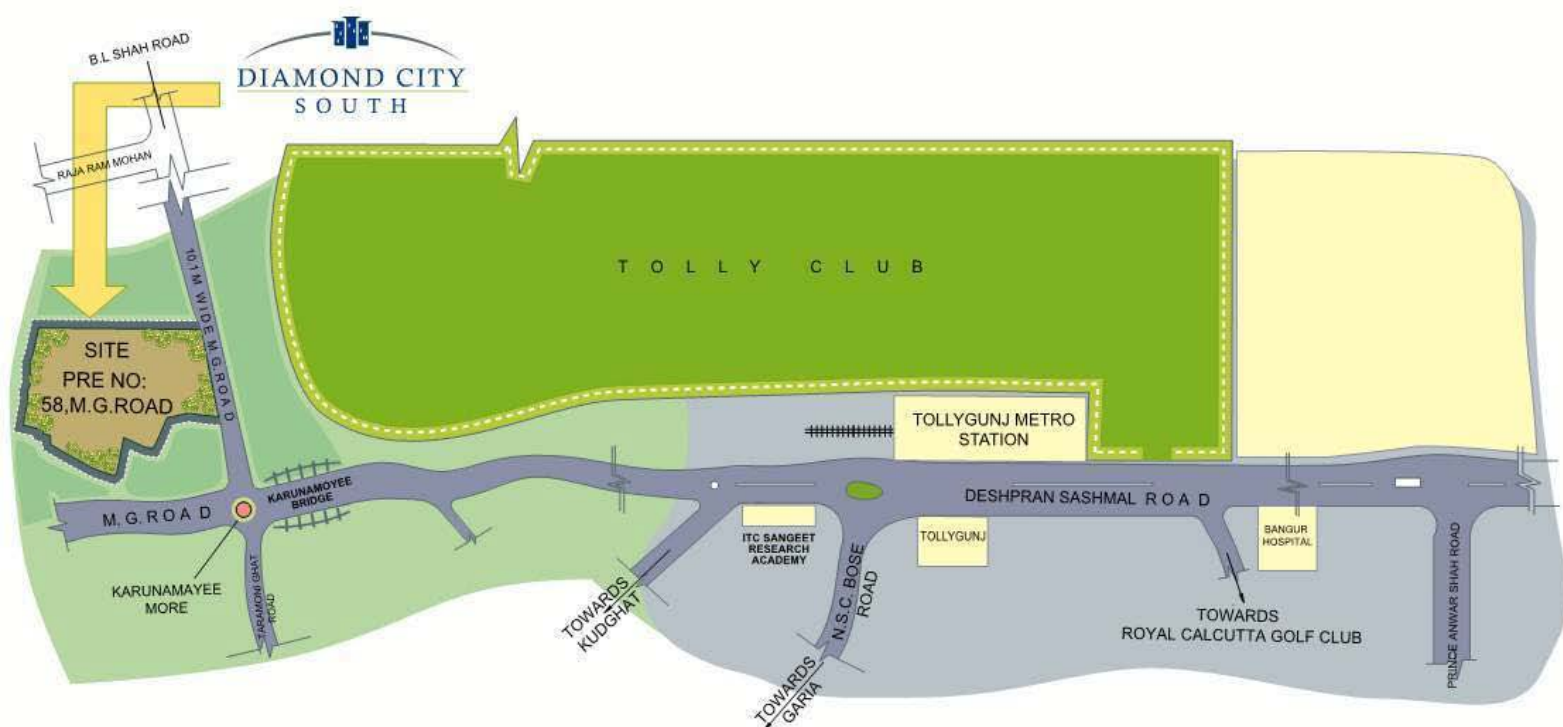

Type & Area

Ground Floor Plan



DIAMOND CITY SOUTH



THE DESIGN CELL
ARCHITECTS, ENGINEERS, INTERIOR DESIGNERS
2A COOPER STREET
KOLKATA - 700 026

Typical Floor Plan 1st to 21st Floor

Flet Type	Bed Room	Built-up Area	Super Built-up Area
A	3	1274	1843
B	3	1058	1476
C	3	1113	1435
D	2	920	1187
E	2	920	1187
F	3	1274	1843
G	3	1058	1476
H	3	1113	1435

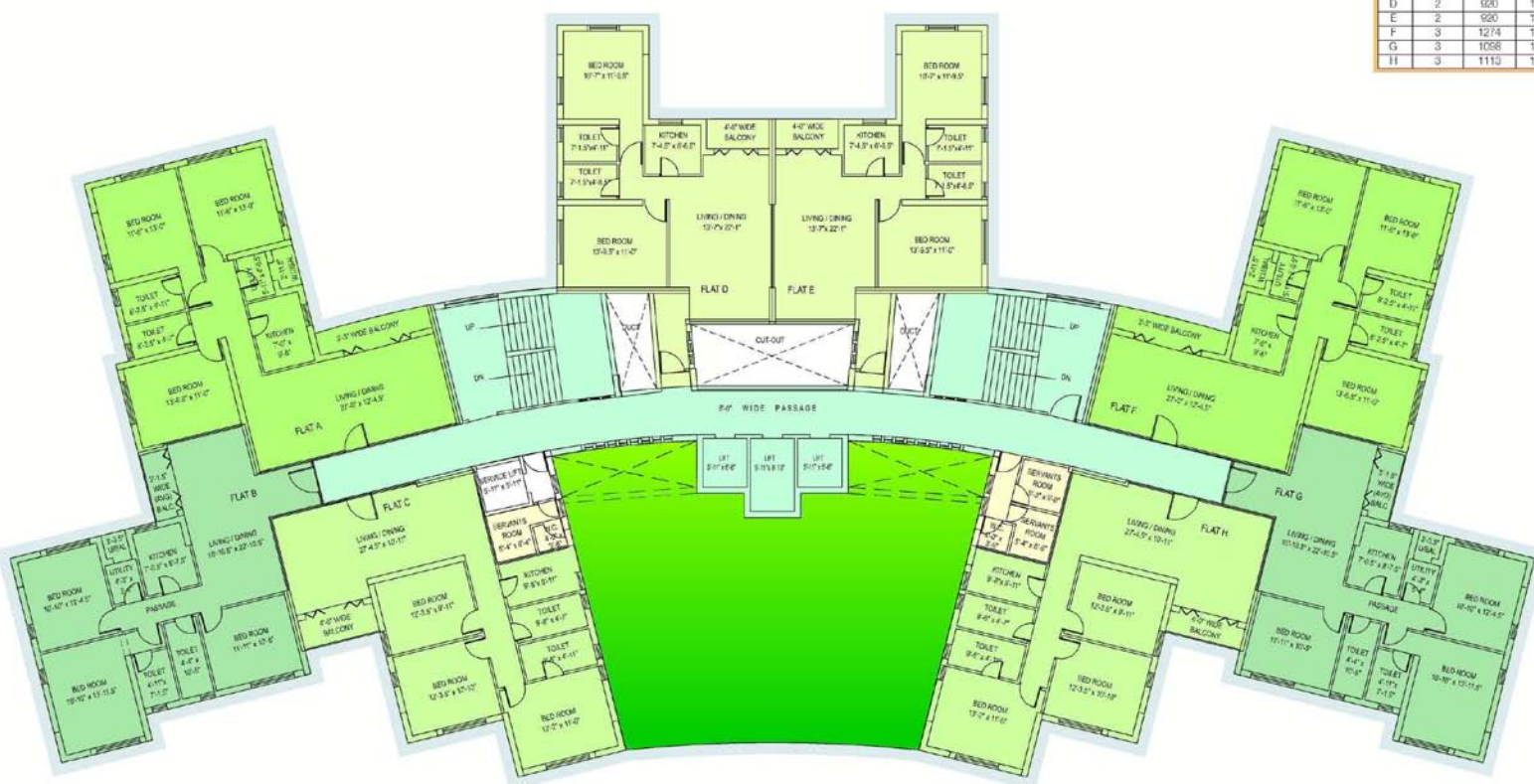

Typical Floor Plan
1st to 21st Floor

Exiting Floor plan

Developer

South City Group

ARCHITECT



The Design Cell



12-A, Lord Sinha Road, Shyamkunj Appt.
Flat # 403, Kolkata 700071 WB

+91 81004 44477



sales@rabcoestates.com